

## MUDGUARD MOUNTING ARMS - TRI BOLT STRAIGHT

- Traditional 3-Bolt Fixing Method.
- Slotted base Plate holes to facilitate easier fitment.
- Available in 3 tube diameters.
- Supplied with plastic end plugs.
- Finished in a high quality protective zinc plate.
- Available straight or cranked.
- Bespoke arm manufacturing available upon request.

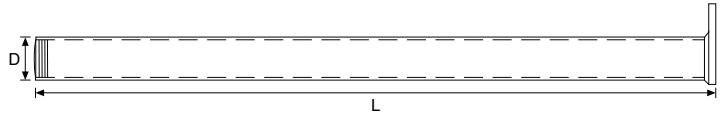
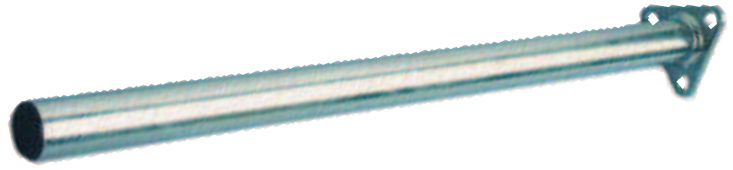

STRAIGHT MOUNTING ARM - TRIANGULAR BASE PLATE		
PART NO.	LENGTH (L)	DIAMETER (D)
<b>TU35A640</b>	640mm	35mm
<b>TU35A700</b>	700mm	35mm
<b>TU35A780</b>	780mm	35mm
<b>TU42A640</b>	640mm	35mm
<b>TU42A700</b>	700mm	42mm
<b>TU42A780</b>	780mm	42mm
<b>TU48A700</b>	700mm	48mm
<b>TU48A780</b>	780mm	48mm

## MUDGUARD MOUNTING ARMS - TRI BOLT CRANKED

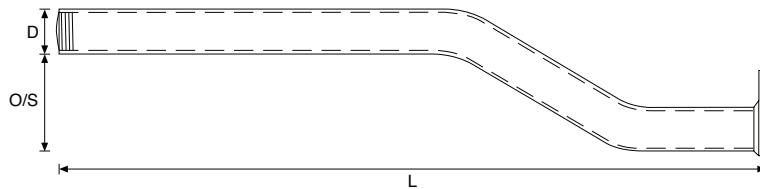
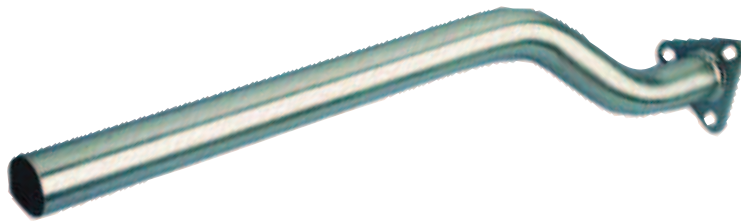

CRANKED MOUNTING ARM - 100mm OFFSET - TRIANGULAR BASE PLATE		
PART NO.	LENGTH (L)	DIAMETER (D)
<b>CR35A700</b>	700mm	35mm
<b>CR35A780</b>	780mm	35mm
<b>CR42A700</b>	700mm	42mm
<b>CR42A780</b>	780mm	42mm
<b>CR48A700</b>	700mm	48mm
<b>CR48A780</b>	780mm	48mm

All dimensions nominal.

The manufacturer reserves the right to alter sizes, specifications etc. without prior notice